

SILVERTHIN SG045XPO**4.5 in Open Type X Thin Section Bearing****Specifications**

Bore (B)	4.500 in
Outside Diameter (D)	6.500 in
Width	1"
Land Diameter (L ₁)	5.242 in
Land Diameter (L ₂)	5.758 in
Approximate Weight	4.00 lbs
Separator	Brass; snapover separator
Precision Class	ABEC Class 1
Bearing Type	4-Point Contact (Type X)
Seals, Shields	None (Open)
Unit System	Inch

Load Capacities

Static Radial Load	8,760 lbf
Dynamic Radial Load	8,205 lbf
Static Thrust Load	21,890 lbf
Dynamic Thrust Load	11,750 lbf
Static Moment Load	24,080 in-lbs
Dynamic Moment Load	16,930 in-lbs

Interchange

Silverthin	SG045XPO	Kaydon	KG045XPO	Kaydon	KG045XPO	INA	CSXG045
SKF	FPXG408	FAG	L18WA400	NSK	NBX11425	NTN	KXG045
SSB	RG045XPO	RBC	KG045XPO*RBC				

Brass; snapover separator

1/2" balls

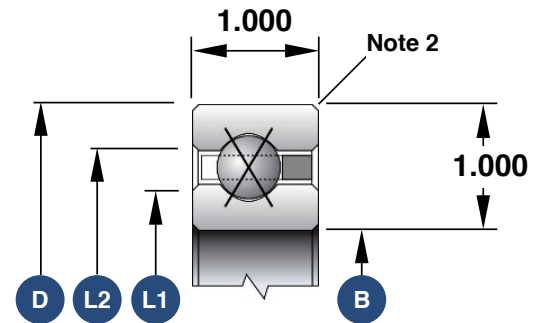

1. Load capacities are not additive
2. The maximum shaft or housing fillet radius that the bearing corners will clear for this series is 0.080"
3. Race Width Tolerance: +0.000 -0.005"

Also Available

Open Angular Contact	SG045AR0
Open Radial Contact	SG045CP0
Open Duplexed (Back-to-Back)	SG045BR0
Open Duplexed (Face-to-Face)	SG045FR0