

SILVERTHIN SG047AR0**4.75 in Open Type A Thin Section Bearing****Specifications**

Bore (B)	4.750 in
Outside Diameter (D)	6.750 in
Width	1"
Land Diameter (L ₁)	5.492 in
Land Diameter (L ₂)	6.008 in
Land Diameter (L ₃)	6.239 in
Approximate Weight	4.10 lbs
Separator	Brass; one piece pocket separator
Precision Class	ABEC Class 1
Bearing Type	Angular Contact (Type A)
Seals, Shields	None (Open)
Unit System	Inch

Load Capacities

Static Radial Load	10,900 lbf
Dynamic Radial Load	6,745 lbf
Static Thrust Load	31,460 lbf
Dynamic Thrust Load	14,970 lbf

Interchange

Silverthin	SG047AR0	Kaydon	KG047AR0
SKF	FPAG412	FAG	L15WA408
SSB	RG047AR0	RBC	KG047AR0*RBC

Brass; one piece pocket separator

1/2" balls

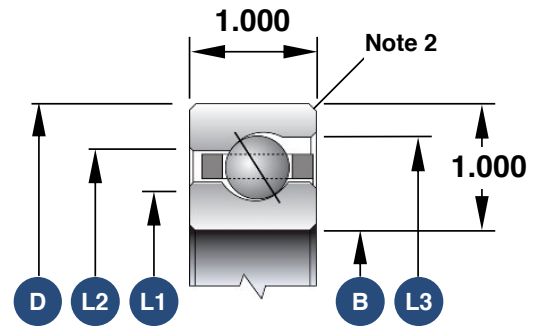

1. Load capacities are not additive
2. The maximum shaft or housing fillet radius that the bearing corners will clear for this series is 0.080"
3. Race Width Tolerance: +0.000 -0.005"

Also Available

Open Radial Contact	SG047CP0
Open 4-Point Contact	SG047XP0
Open Duplexed (Back-to-Back)	SG047BR0
Open Duplexed (Face-to-Face)	SG047FR0