

SILVERTHIN SG047CP0**4.75 in Open Type C Thin Section Bearing****Specifications**

Bore (B)	4.750 in
Outside Diameter (D)	6.750 in
Width	1"
Land Diameter (L ₁)	5.492 in
Land Diameter (L ₂)	6.008 in
Approximate Weight	4.10 lbs
Separator	Brass; snapover separator
Precision Class	ABEC Class 1
Bearing Type	Radial Contact (Type C)
Seals, Shields	None (Open)
Unit System	Inch

Load Capacities

Static Radial Load	9,300 lbf
Dynamic Radial Load	6,485 lbf

Interchange

Silverthin	SG047CP0	Kaydon	KG047CP0	Kaydon	KG047CP0	INA	CSCG047
SKF	FPCG412	FAG	L10WA408	NSK	NBC12025	NTN	KRG047
SSB	RG047CP0	RBC	KG047CP0*RBC				

Brass; snapover separator

1/2" balls

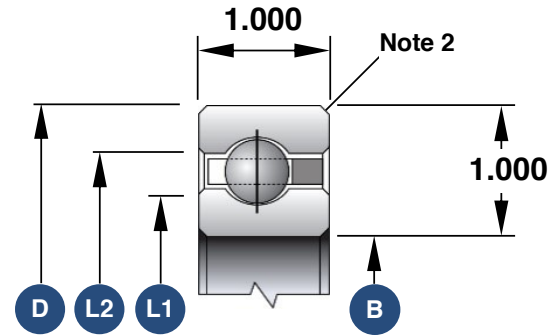

1. Load capacities are not additive
2. The maximum shaft or housing fillet radius that the bearing corners will clear for this series is 0.080"
3. Race Width Tolerance: +0.000 -0.005"

Also Available

Open Angular Contact	SG047AR0
Open 4-Point Contact	SG047XP0
Open Duplexed (Back-to-Back)	SG047BR0
Open Duplexed (Face-to-Face)	SG047FR0