

SILVERTHIN SG047XP0**4.75 in Open Type X Thin Section Bearing****Specifications**

| | |
|---------------------------------|---------------------------|
| Bore (B) | 4.750 in |
| Outside Diameter (D) | 6.750 in |
| Width | 1" |
| Land Diameter (L ₁) | 5.492 in |
| Land Diameter (L ₂) | 6.008 in |
| Approximate Weight | 4.10 lbs |
| Separator | Brass; snapover separator |
| Precision Class | ABEC Class 1 |
| Bearing Type | 4-Point Contact (Type X) |
| Seals, Shields | None (Open) |
| Unit System | Inch |

Load Capacities

| | |
|---------------------|---------------|
| Static Radial Load | 9,300 lbf |
| Dynamic Radial Load | 8,485 lbf |
| Static Thrust Load | 23,260 lbf |
| Dynamic Thrust Load | 12,230 lbf |
| Static Moment Load | 26,740 in-lbs |
| Dynamic Moment Load | 18,305 in-lbs |

Interchange

| | | | | | | | |
|------------|-----------------|--------|---------------------|--------|-----------------|-----|----------------|
| Silverthin | SG047XP0 | Kaydon | KG047XP0 | Kaydon | KG047XP0 | INA | CSXG047 |
| SKF | FPXG412 | FAG | L18WA408 | NSK | NBX12025 | NTN | KXG047 |
| SSB | RG047XP0 | RBC | KG047XP0*RBC | | | | |

Brass; snapover separator

1/2" balls

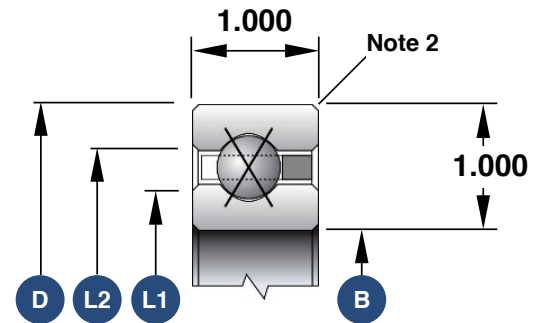

1. Load capacities are not additive
2. The maximum shaft or housing fillet radius that the bearing corners will clear for this series is 0.080"
3. Race Width Tolerance: +0.000 -0.005"

Also Available

| | |
|------------------------------|-----------------|
| Open Angular Contact | SG047AR0 |
| Open Radial Contact | SG047CP0 |
| Open Duplexed (Back-to-Back) | SG047BR0 |
| Open Duplexed (Face-to-Face) | SG047FR0 |