

SILVERTHIN SG050AR0**5 in Open Type A Thin Section Bearing****Specifications**

Bore (B)	5.000 in
Outside Diameter (D)	7.000 in
Width	1"
Land Diameter (L ₁)	5.742 in
Land Diameter (L ₂)	6.258 in
Land Diameter (L ₃)	6.489 in
Approximate Weight	4.30 lbs
Separator	Brass; one piece pocket separator
Precision Class	ABEC Class 1
Bearing Type	Angular Contact (Type A)
Seals, Shields	None (Open)
Unit System	Inch

Load Capacities

Static Radial Load	11,370 lbf
Dynamic Radial Load	6,895 lbf
Static Thrust Load	32,830 lbf
Dynamic Thrust Load	15,400 lbf

Interchange

Silverthin	SG050AR0	Kaydon	KG050AR0
SKF	FPAG500	FAG	L15WA500
SSB	RG050AR0	RBC	KG050AR0*RBC

Brass; one piece pocket separator

1/2" balls

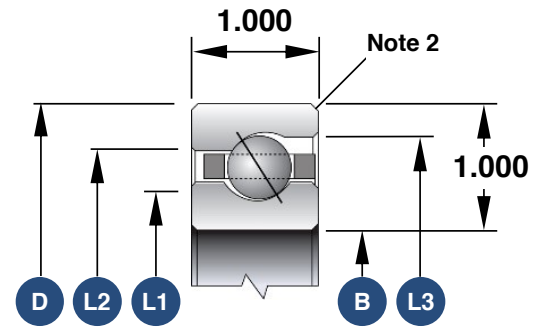

1. Load capacities are not additive
2. The maximum shaft or housing fillet radius that the bearing corners will clear for this series is 0.080"
3. Race Width Tolerance: +0.000 -0.005"

Also Available

Open Radial Contact	SG050CP0
Open 4-Point Contact	SG050XP0
Open Duplexed (Back-to-Back)	SG050BR0
Open Duplexed (Face-to-Face)	SG050FR0