

SILVERTHIN SG050CP0**5 in Open Type C Thin Section Bearing****Specifications**

Bore (B)	5.000 in
Outside Diameter (D)	7.000 in
Width	1"
Land Diameter (L ₁)	5.742 in
Land Diameter (L ₂)	6.258 in
Approximate Weight	4.30 lbs
Separator	Brass; snapover separator
Precision Class	ABEC Class 1
Bearing Type	Radial Contact (Type C)
Seals, Shields	None (Open)
Unit System	Inch

Load Capacities

Static Radial Load	9,850 lbf
Dynamic Radial Load	6,690 lbf

Interchange

Silverthin	SG050CP0	Kaydon	KG050CP0	Kaydon	KG050CP0	INA	CSCG050
SKF	FPCG500	FAG	L10WA500	NSK	NBC12725	NTN	KRG050
SSB	RG050CP0	RBC	KG050CP0*RBC				

Brass; snapover separator

1/2" balls

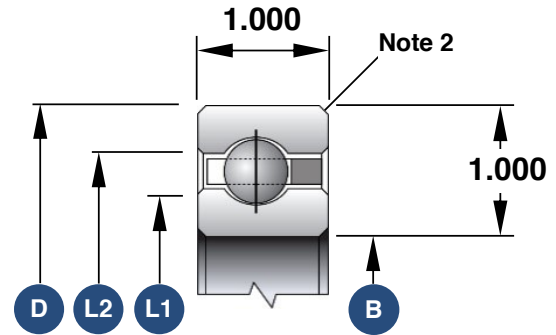

1. Load capacities are not additive
2. The maximum shaft or housing fillet radius that the bearing corners will clear for this series is 0.080"
3. Race Width Tolerance: +0.000 -0.005"

Also Available

Open Angular Contact	SG050AR0
Open 4-Point Contact	SG050XP0
Open Duplexed (Back-to-Back)	SG050BR0
Open Duplexed (Face-to-Face)	SG050FR0