

SILVERTHIN SG050XPO**5 in Open Type X Thin Section Bearing****Specifications**

Bore (B)	5.000 in
Outside Diameter (D)	7.000 in
Width	1"
Land Diameter (L ₁)	5.742 in
Land Diameter (L ₂)	6.258 in
Approximate Weight	4.30 lbs
Separator	Brass; snapover separator
Precision Class	ABEC Class 1
Bearing Type	4-Point Contact (Type X)
Seals, Shields	None (Open)
Unit System	Inch

Load Capacities

Static Radial Load	9,850 lbf
Dynamic Radial Load	8,760 lbf
Static Thrust Load	24,620 lbf
Dynamic Thrust Load	12,710 lbf
Static Moment Load	29,550 in-lbs
Dynamic Moment Load	19,720 in-lbs

Interchange

Silverthin	SG050XPO	Kaydon	KG050XPO	Kaydon	KG050XPO	INA	CSXG050
SKF	FPXG500	FAG	L18WA500	NSK	NBX12725	NTN	KXG050
SSB	RG050XPO	RBC	KG050XPO*RBC				

Brass; snapover separator

1/2" balls

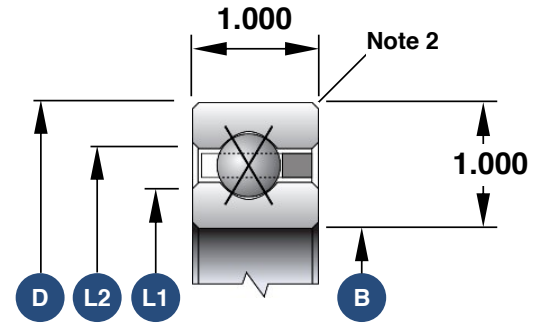

1. Load capacities are not additive
2. The maximum shaft or housing fillet radius that the bearing corners will clear for this series is 0.080"
3. Race Width Tolerance: +0.000 -0.005"

Also Available

Open Angular Contact	SG050AR0
Open Radial Contact	SG050CP0
Open Duplexed (Back-to-Back)	SG050BR0
Open Duplexed (Face-to-Face)	SG050FR0