

SILVERTHIN SG055ARO**5.5 in Open Type A Thin Section Bearing****Specifications**

Bore (B)	5.500 in
Outside Diameter (D)	7.500 in
Width	1"
Land Diameter (L ₁)	6.242 in
Land Diameter (L ₂)	6.758 in
Land Diameter (L ₃)	6.989 in
Approximate Weight	4.70 lbs
Separator	Brass; one piece pocket separator
Precision Class	ABEC Class 1
Bearing Type	Angular Contact (Type A)
Seals, Shields	None (Open)
Unit System	Inch

Load Capacities

Static Radial Load	12,320 lbf
Dynamic Radial Load	7,190 lbf
Static Thrust Load	35,570 lbf
Dynamic Thrust Load	16,240 lbf

Interchange

Silverthin	SG055ARO	Kaydon	KG055ARO
SKF	FPAG508	FAG	L15WA508
SSB	RG055ARO	RBC	KG055ARO*RBC

Brass; one piece pocket separator

1/2" balls

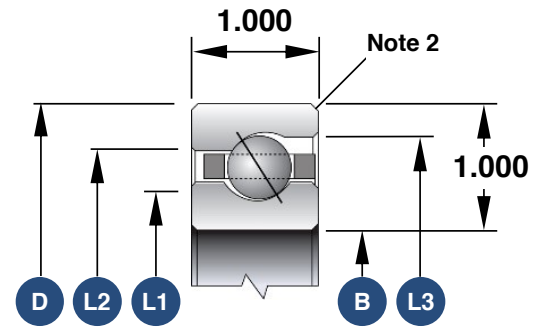

1. Load capacities are not additive
2. The maximum shaft or housing fillet radius that the bearing corners will clear for this series is 0.080"
3. Race Width Tolerance: +0.000 -0.005"

Also Available

Open Radial Contact	SG055CP0
Open 4-Point Contact	SG055XP0
Open Duplexed (Back-to-Back)	SG055BR0
Open Duplexed (Face-to-Face)	SG055FR0