

SILVERTHIN SG055CP0**5.5 in Open Type C Thin Section Bearing****Specifications**

Bore (B)	5.500 in
Outside Diameter (D)	7.500 in
Width	1"
Land Diameter (L ₁)	6.242 in
Land Diameter (L ₂)	6.758 in
Approximate Weight	4.70 lbs
Separator	Brass; snapover separator
Precision Class	ABEC Class 1
Bearing Type	Radial Contact (Type C)
Seals, Shields	None (Open)
Unit System	Inch

Load Capacities

Static Radial Load	10,400 lbf
Dynamic Radial Load	6,850 lbf

Interchange

Silverthin	SG055CP0	Kaydon	KG055CP0	Kaydon	KG055CP0	INA	CSCG055
SKF	FPCG508	FAG	L10WA508	NSK	NBC13925	NTN	KRG055
SSB	RG055CP0	RBC	KG055CP0*RBC				

Brass; snapover separator

1/2" balls

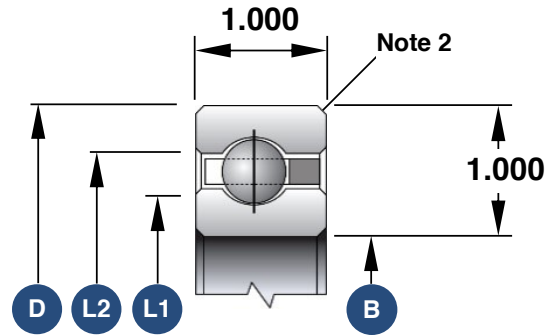

1. Load capacities are not additive
2. The maximum shaft or housing fillet radius that the bearing corners will clear for this series is 0.080"
3. Race Width Tolerance: +0.000 -0.005"

Also Available

Open Angular Contact	SG055AR0
Open 4-Point Contact	SG055XP0
Open Duplexed (Back-to-Back)	SG055BR0
Open Duplexed (Face-to-Face)	SG055FR0