

SILVERTHIN SG055XPO**5.5 in Open Type X Thin Section Bearing****Specifications**

Bore (B)	5.500 in
Outside Diameter (D)	7.500 in
Width	1"
Land Diameter (L ₁)	6.242 in
Land Diameter (L ₂)	6.758 in
Approximate Weight	4.70 lbs
Separator	Brass; snapover separator
Precision Class	ABEC Class 1
Bearing Type	4-Point Contact (Type X)
Seals, Shields	None (Open)
Unit System	Inch

Load Capacities

Static Radial Load	10,400 lbf
Dynamic Radial Load	8,980 lbf
Static Thrust Load	25,990 lbf
Dynamic Thrust Load	13,180 lbf
Static Moment Load	33,790 in-lbs
Dynamic Moment Load	21,895 in-lbs

Interchange

Silverthin	SG055XPO	Kaydon	KG055XPO	Kaydon	KG055XPO	INA	CSXG055
SKF	FPXG508	FAG	L18WA508	NSK	NBX13925	NTN	KXG055
SSB	RG055XPO	RBC	KG055XPO*RBC				

Brass; snapover separator

1/2" balls

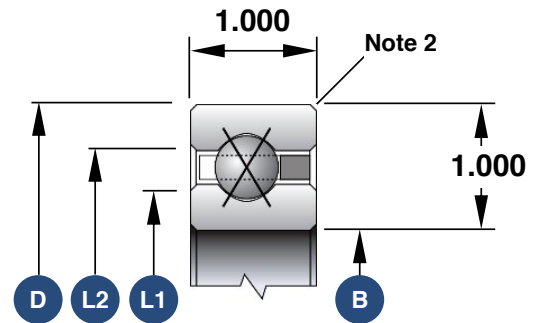

1. Load capacities are not additive
2. The maximum shaft or housing fillet radius that the bearing corners will clear for this series is 0.080"
3. Race Width Tolerance: +0.000 -0.005"

Also Available

Open Angular Contact	SG055AR0
Open Radial Contact	SG055CP0
Open Duplexed (Back-to-Back)	SG055BR0
Open Duplexed (Face-to-Face)	SG055FR0