

SILVERTHIN SG060AR0**6 in Open Type A Thin Section Bearing****Specifications**

Bore (B)	6.000 in
Outside Diameter (D)	8.000 in
Width	1"
Land Diameter (L ₁)	6.742 in
Land Diameter (L ₂)	7.258 in
Land Diameter (L ₃)	7.489 in
Approximate Weight	5.10 lbs
Separator	Brass; one piece pocket separator
Precision Class	ABEC Class 1
Bearing Type	Angular Contact (Type A)
Seals, Shields	None (Open)
Unit System	Inch

Load Capacities

Static Radial Load	13,270 lbf
Dynamic Radial Load	7,480 lbf
Static Thrust Load	38,300 lbf
Dynamic Thrust Load	17,060 lbf

Interchange

Silverthin	SG060AR0	Kaydon	KG060AR0
SKF	FPAG600	FAG	L15WA600
SSB	RG060AR0	RBC	KG060AR0*RBC

Brass; one piece pocket separator

1/2" balls

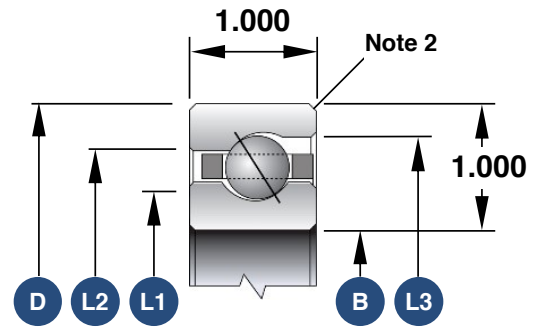

1. Load capacities are not additive
2. The maximum shaft or housing fillet radius that the bearing corners will clear for this series is 0.080"
3. Race Width Tolerance: +0.000 -0.005"

Also Available

Open Radial Contact	SG060CP0
Open 4-Point Contact	SG060XP0
Open Duplexed (Back-to-Back)	SG060BR0
Open Duplexed (Face-to-Face)	SG060FR0