

SILVERTHIN SG060CP0**6 in Open Type C Thin Section Bearing****Specifications**

Bore (B)	6.000 in
Outside Diameter (D)	8.000 in
Width	1"
Land Diameter (L ₁)	6.742 in
Land Diameter (L ₂)	7.258 in
Approximate Weight	5.10 lbs
Separator	Brass; snapover separator
Precision Class	ABEC Class 1
Bearing Type	Radial Contact (Type C)
Seals, Shields	None (Open)
Unit System	Inch

Load Capacities

Static Radial Load	11,490 lbf
Dynamic Radial Load	7,240 lbf

Interchange

Silverthin	SG060CP0	Kaydon	KG060CP0	Kaydon	KG060CP0	INA	CSCG060
SKF	FPCG600	FAG	L10WA600	NSK	NBC15225	NTN	KRG060
SSB	RG060CP0	RBC	KG060CP0*RBC				

Brass; snapover separator

1/2" balls

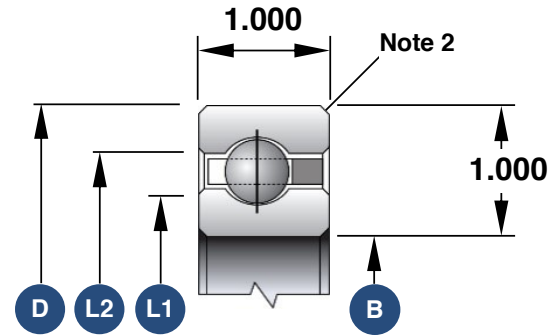

1. Load capacities are not additive
2. The maximum shaft or housing fillet radius that the bearing corners will clear for this series is 0.080"
3. Race Width Tolerance: +0.000 -0.005"

Also Available

Open Angular Contact	SG060AR0
Open 4-Point Contact	SG060XP0
Open Duplexed (Back-to-Back)	SG060BR0
Open Duplexed (Face-to-Face)	SG060FR0