

SILVERTHIN SG060XPO**6 in Open Type X Thin Section Bearing****Specifications**

Bore (B)	6.000 in
Outside Diameter (D)	8.000 in
Width	1"
Land Diameter (L ₁)	6.742 in
Land Diameter (L ₂)	7.258 in
Approximate Weight	5.10 lbs
Separator	Brass; snapover separator
Precision Class	ABEC Class 1
Bearing Type	4-Point Contact (Type X)
Seals, Shields	None (Open)
Unit System	Inch

Load Capacities

Static Radial Load	11,490 lbf
Dynamic Radial Load	9,505 lbf
Static Thrust Load	28,730 lbf
Dynamic Thrust Load	14,090 lbf
Static Moment Load	40,220 in-lbs
Dynamic Moment Load	24,955 in-lbs

Interchange

Silverthin	SG060XPO	Kaydon	KG060XPO	Kaydon	KG060XPO	INA	CSXG060
SKF	FPXG600	FAG	L18WA600	NSK	NBX15225	NTN	KXG060
SSB	RG060XPO	RBC	KG060XPO*RBC				

Brass; snapover separator

1/2" balls

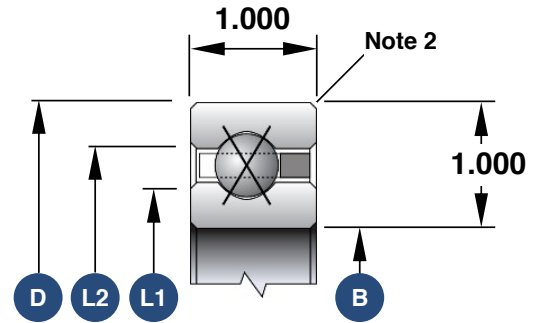

1. Load capacities are not additive
2. The maximum shaft or housing fillet radius that the bearing corners will clear for this series is 0.080"
3. Race Width Tolerance: +0.000 -0.005"

Also Available

Open Angular Contact	SG060AR0
Open Radial Contact	SG060CP0
Open Duplexed (Back-to-Back)	SG060BR0
Open Duplexed (Face-to-Face)	SG060FR0