

SILVERTHIN SG065ARO**6.5 in Open Type A Thin Section Bearing****Specifications**

Bore (B)	6.500 in
Outside Diameter (D)	8.500 in
Width	1"
Land Diameter (L ₁)	7.242 in
Land Diameter (L ₂)	7.758 in
Land Diameter (L ₃)	7.987 in
Approximate Weight	5.40 lbs
Separator	Brass; one piece pocket separator
Precision Class	ABEC Class 1
Bearing Type	Angular Contact (Type A)
Seals, Shields	None (Open)
Unit System	Inch

Load Capacities

Static Radial Load	14,220 lbf
Dynamic Radial Load	7,760 lbf
Static Thrust Load	41,040 lbf
Dynamic Thrust Load	17,870 lbf

Interchange

Silverthin	SG065ARO	Kaydon	KG065ARO
SKF	FPAG608	FAG	L15WA608
SSB	RG065ARO	RBC	KG065ARO*RBC

Brass; one piece pocket separator

1/2" balls

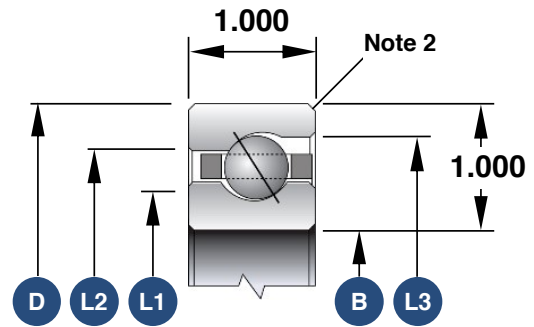

1. Load capacities are not additive
2. The maximum shaft or housing fillet radius that the bearing corners will clear for this series is 0.080"
3. Race Width Tolerance: +0.000 -0.005"

Also Available

Open Radial Contact	SG065CP0
Open 4-Point Contact	SG065XP0
Open Duplexed (Back-to-Back)	SG065BR0
Open Duplexed (Face-to-Face)	SG065FR0