

Specifications

Bore (B)	6.500 in
Outside Diameter (D)	8.500 in
Width	1"
Land Diameter (L <sub>1</sub> )	7.242 in
Land Diameter (L <sub>2</sub> )	7.758 in
Approximate Weight	5.40 lbs
Separator	Brass; snapover separator
Precision Class	ABEC Class 1
Bearing Type	4-Point Contact (Type X)
Seals, Shields	None (Open)
Unit System	Inch

Load Capacities

Static Radial Load	12,040 lbf
Dynamic Radial Load	9,715 lbf
Static Thrust Load	30,100 lbf
Dynamic Thrust Load	14,530 lbf
Static Moment Load	45,140 in-lbs
Dynamic Moment Load	27,325 in-lbs

Interchange

Silverthin	SG065XP0	Kaydon	KG065XP0	Kaydon	KG065XP0	INA	CSXG065
SKF	FPXG608	FAG	L18WA608	NSK	NBX16525	NTN	KXG065
SSB	RG065XP0	RBC	KG065XP0*RBC				

Brass; snapover separator  
1/2" balls

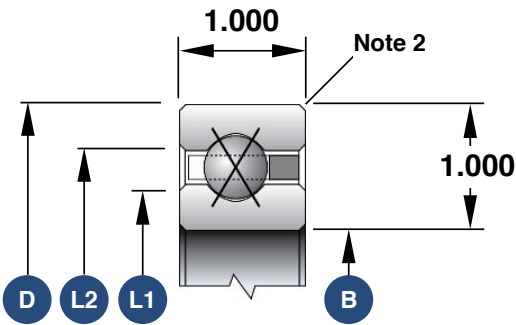

- 1. Load capacities are not additive
- 2. The maximum shaft or housing fillet radius that the bearing corners will clear for this series is 0.080"
- 3. Race Width Tolerance: +0.000 -0.005"

Also Available

Open Angular Contact	SG065AR0
Open Radial Contact	SG065CP0
Open Duplexed (Back-to-Back)	SG065BR0
Open Duplexed (Face-to-Face)	SG065FR0