

SILVERTHIN SG070AR0**7 in Open Type A Thin Section Bearing****Specifications**

Bore (B)	7.000 in
Outside Diameter (D)	9.000 in
Width	1"
Land Diameter (L ₁)	7.742 in
Land Diameter (L ₂)	8.258 in
Land Diameter (L ₃)	8.487 in
Approximate Weight	5.80 lbs
Separator	Brass; one piece pocket separator
Precision Class	ABEC Class 1
Bearing Type	Angular Contact (Type A)
Seals, Shields	None (Open)
Unit System	Inch

Load Capacities

Static Radial Load	15,160 lbf
Dynamic Radial Load	8,035 lbf
Static Thrust Load	43,780 lbf
Dynamic Thrust Load	18,650 lbf

Interchange

Silverthin	SG070AR0	Kaydon	KG070AR0
SKF	FPAG700	FAG	L15WA700
SSB	RG070AR0	RBC	KG070AR0*RBC

Brass; one piece pocket separator

1/2" balls

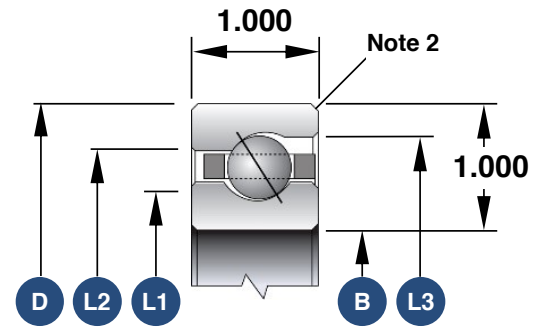

1. Load capacities are not additive
2. The maximum shaft or housing fillet radius that the bearing corners will clear for this series is 0.080"
3. Race Width Tolerance: +0.000 -0.005"

Also Available

Open Radial Contact	SG070CP0
Open 4-Point Contact	SG070XP0
Open Duplexed (Back-to-Back)	SG070BR0
Open Duplexed (Face-to-Face)	SG070FR0