

**SILVERTHIN SG070CP0****7 in Open Type C Thin Section Bearing****Specifications**

|                                 |                           |
|---------------------------------|---------------------------|
| Bore (B)                        | 7.000 in                  |
| Outside Diameter (D)            | 9.000 in                  |
| Width                           | 1"                        |
| Land Diameter (L <sub>1</sub> ) | 7.742 in                  |
| Land Diameter (L <sub>2</sub> ) | 8.258 in                  |
| Approximate Weight              | 5.80 lbs                  |
| Separator                       | Brass; snapover separator |
| Precision Class                 | ABEC Class 1              |
| Bearing Type                    | Radial Contact (Type C)   |
| Seals, Shields                  | None (Open)               |
| Unit System                     | Inch                      |

**Load Capacities**

|                     |            |
|---------------------|------------|
| Static Radial Load  | 13,130 lbf |
| Dynamic Radial Load | 7,765 lbf  |

**Interchange**

|            |                          |        |                              |        |                          |     |                         |
|------------|--------------------------|--------|------------------------------|--------|--------------------------|-----|-------------------------|
| Silverthin | <a href="#">SG070CP0</a> | Kaydon | <a href="#">KG070CP0</a>     | Kaydon | <a href="#">KG070CP0</a> | INA | <a href="#">CSCG070</a> |
| SKF        | <a href="#">FPCG700</a>  | FAG    | <a href="#">L10WA700</a>     | NSK    | <a href="#">NBC17725</a> | NTN | <a href="#">KRG070</a>  |
| SSB        | <a href="#">RG070CP0</a> | RBC    | <a href="#">KG070CP0*RBC</a> |        |                          |     |                         |

**Brass; snapover separator**

1/2" balls

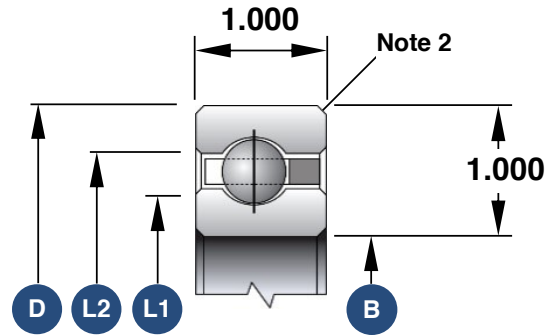

1. Load capacities are not additive
2. The maximum shaft or housing fillet radius that the bearing corners will clear for this series is 0.080"
3. Race Width Tolerance: +0.000 -0.005"

**Also Available**

|                              |                          |
|------------------------------|--------------------------|
| Open Angular Contact         | <a href="#">SG070AR0</a> |
| Open 4-Point Contact         | <a href="#">SG070XP0</a> |
| Open Duplexed (Back-to-Back) | <a href="#">SG070BR0</a> |
| Open Duplexed (Face-to-Face) | <a href="#">SG070FR0</a> |