

SILVERTHIN SG070XPO**7 in Open Type X Thin Section Bearing****Specifications**

Bore (B)	7.000 in
Outside Diameter (D)	9.000 in
Width	1"
Land Diameter (L ₁)	7.742 in
Land Diameter (L ₂)	8.258 in
Approximate Weight	5.80 lbs
Separator	Brass; snapover separator
Precision Class	ABEC Class 1
Bearing Type	4-Point Contact (Type X)
Seals, Shields	None (Open)
Unit System	Inch

Load Capacities

Static Radial Load	13,130 lbf
Dynamic Radial Load	10,210 lbf
Static Thrust Load	32,830 lbf
Dynamic Thrust Load	15,400 lbf
Static Moment Load	52,530 in-lbs
Dynamic Moment Load	30,635 in-lbs

Interchange

Silverthin	SG070XPO	Kaydon	KG070XPO	Kaydon	KG070XPO	INA	CSXG070
SKF	FPXG700	FAG	L18WA700	NSK	NBX17725	NTN	KXG070
SSB	RG070XPO	RBC	KG070XPO*RBC				

Brass; snapover separator

1/2" balls

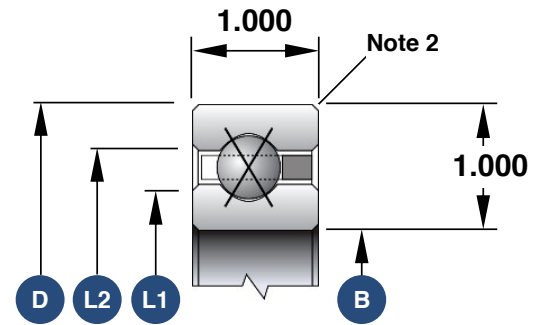

1. Load capacities are not additive
2. The maximum shaft or housing fillet radius that the bearing corners will clear for this series is 0.080"
3. Race Width Tolerance: +0.000 -0.005"

Also Available

Open Angular Contact	SG070AR0
Open Radial Contact	SG070CP0
Open Duplexed (Back-to-Back)	SG070BR0
Open Duplexed (Face-to-Face)	SG070FR0