

SILVERTHIN SG075ARO**7.5 in Open Type A Thin Section Bearing****Specifications**

Bore (B)	7.500 in
Outside Diameter (D)	9.500 in
Width	1"
Land Diameter (L ₁)	8.242 in
Land Diameter (L ₂)	8.758 in
Land Diameter (L ₃)	8.987 in
Approximate Weight	6.10 lbs
Separator	Brass; one piece pocket separator
Precision Class	ABEC Class 1
Bearing Type	Angular Contact (Type A)
Seals, Shields	None (Open)
Unit System	Inch

Load Capacities

Static Radial Load	16,110 lbf
Dynamic Radial Load	8,305 lbf
Static Thrust Load	46,510 lbf
Dynamic Thrust Load	19,420 lbf

Interchange

Silverthin	SG075ARO	Kaydon	KG075ARO
SKF	FPAG708	FAG	L15WA708
SSB	RG075ARO	RBC	KG075ARO*RBC

Brass; one piece pocket separator

1/2" balls

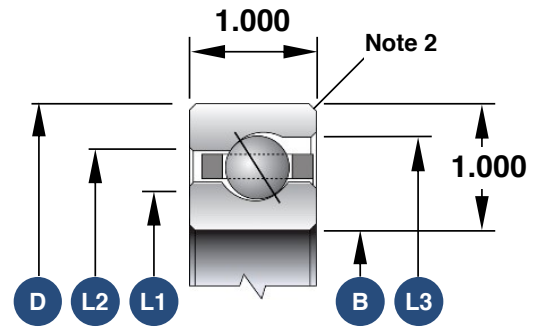

1. Load capacities are not additive
2. The maximum shaft or housing fillet radius that the bearing corners will clear for this series is 0.080"
3. Race Width Tolerance: +0.000 -0.005"

Also Available

Open Radial Contact	SG075CP0
Open 4-Point Contact	SG075XP0
Open Duplexed (Back-to-Back)	SG075BR0
Open Duplexed (Face-to-Face)	SG075FR0