

SILVERTHIN SG075CP0**7.5 in Open Type C Thin Section Bearing****Specifications**

Bore (B)	7.500 in
Outside Diameter (D)	9.500 in
Width	1"
Land Diameter (L ₁)	8.242 in
Land Diameter (L ₂)	8.758 in
Approximate Weight	6.10 lbs
Separator	Brass; snapover separator
Precision Class	ABEC Class 1
Bearing Type	Radial Contact (Type C)
Seals, Shields	None (Open)
Unit System	Inch

Load Capacities

Static Radial Load	13,680 lbf
Dynamic Radial Load	7,910 lbf

Interchange

Silverthin	SG075CP0	Kaydon	KG075CP0	Kaydon	KG075CP0	INA	CSCG075
SKF	FPCG708	FAG	L10WA708	NSK	NBC19025	NTN	KRG075
SSB	RG075CP0	RBC	KG075CP0*RBC				

Brass; snapover separator

1/2" balls

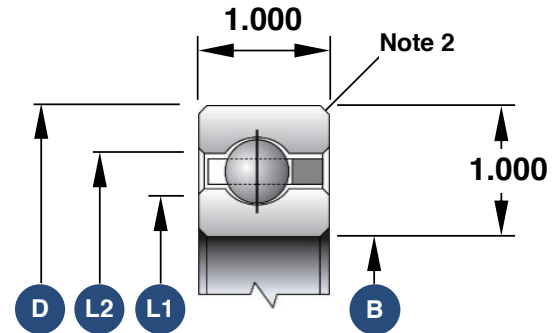

1. Load capacities are not additive
2. The maximum shaft or housing fillet radius that the bearing corners will clear for this series is 0.080"
3. Race Width Tolerance: +0.000 -0.005"

Also Available

Open Angular Contact	SG075AR0
Open 4-Point Contact	SG075XP0
Open Duplexed (Back-to-Back)	SG075BR0
Open Duplexed (Face-to-Face)	SG075FR0