

SILVERTHIN SG075XPO**7.5 in Open Type X Thin Section Bearing****Specifications**

Bore (B)	7.500 in
Outside Diameter (D)	9.500 in
Width	1"
Land Diameter (L ₁)	8.242 in
Land Diameter (L ₂)	8.758 in
Approximate Weight	6.10 lbs
Separator	Brass; snapover separator
Precision Class	ABEC Class 1
Bearing Type	4-Point Contact (Type X)
Seals, Shields	None (Open)
Unit System	Inch

Load Capacities

Static Radial Load	13,680 lbf
Dynamic Radial Load	10,410 lbf
Static Thrust Load	34,200 lbf
Dynamic Thrust Load	15,820 lbf
Static Moment Load	58,140 in-lbs
Dynamic Moment Load	33,195 in-lbs

Interchange

Silverthin	SG075XPO	Kaydon	KG075XPO	Kaydon	KG075XPO	INA	CSXG075
SKF	FPXG708	FAG	L18WA708	NSK	NBX19025	NTN	KXG075
SSB	RG075XPO	RBC	KG075XPO*RBC				

Brass; snapover separator

1/2" balls

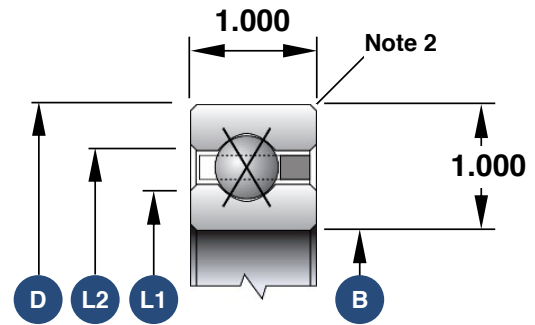

1. Load capacities are not additive
2. The maximum shaft or housing fillet radius that the bearing corners will clear for this series is 0.080"
3. Race Width Tolerance: +0.000 -0.005"

Also Available

Open Angular Contact	SG075AR0
Open Radial Contact	SG075CP0
Open Duplexed (Back-to-Back)	SG075BR0
Open Duplexed (Face-to-Face)	SG075FR0