

SILVERTHIN SG080AR0**8 in Open Type A Thin Section Bearing****Specifications**

| | |
|---------------------------------|-----------------------------------|
| Bore (B) | 8.000 in |
| Outside Diameter (D) | 10.000 in |
| Width | 1" |
| Land Diameter (L ₁) | 8.742 in |
| Land Diameter (L ₂) | 9.258 in |
| Land Diameter (L ₃) | 9.485 in |
| Approximate Weight | 6.50 lbs |
| Separator | Brass; one piece pocket separator |
| Precision Class | ABEC Class 1 |
| Bearing Type | Angular Contact (Type A) |
| Seals, Shields | None (Open) |
| Unit System | Inch |

Load Capacities

| | |
|---------------------|------------|
| Static Radial Load | 17,060 lbf |
| Dynamic Radial Load | 8,565 lbf |
| Static Thrust Load | 49,250 lbf |
| Dynamic Thrust Load | 20,180 lbf |

Interchange

| | | | |
|------------|-----------------|--------|---------------------|
| Silverthin | SG080AR0 | Kaydon | KG080AR0 |
| SKF | FPAG800 | FAG | L15WA800 |
| SSB | RG080AR0 | RBC | KG080AR0*RBC |

Brass; one piece pocket separator

1/2" balls

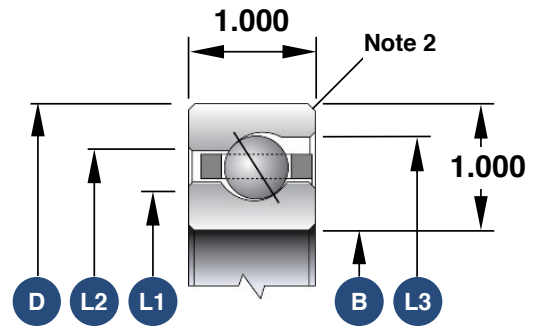

1. Load capacities are not additive
2. The maximum shaft or housing fillet radius that the bearing corners will clear for this series is 0.080"
3. Race Width Tolerance: +0.000 -0.005"

Also Available

| | |
|------------------------------|-----------------|
| Open Radial Contact | SG080CP0 |
| Open 4-Point Contact | SG080XP0 |
| Open Duplexed (Back-to-Back) | SG080BR0 |
| Open Duplexed (Face-to-Face) | SG080FR0 |