

SILVERTHIN SG080XPO**8 in Open Type X Thin Section Bearing****Specifications**

Bore (B)	8.000 in
Outside Diameter (D)	10.000 in
Width	1"
Land Diameter (L ₁)	8.742 in
Land Diameter (L ₂)	9.258 in
Approximate Weight	6.50 lbs
Separator	Brass; snapover separator
Precision Class	ABEC Class 1
Bearing Type	4-Point Contact (Type X)
Seals, Shields	None (Open)
Unit System	Inch

Load Capacities

Static Radial Load	14,770 lbf
Dynamic Radial Load	10,880 lbf
Static Thrust Load	36,940 lbf
Dynamic Thrust Load	16,650 lbf
Static Moment Load	66,480 in-lbs
Dynamic Moment Load	36,745 in-lbs

Interchange

Silverthin	SG080XPO	Kaydon	KG080XPO	Kaydon	KG080XPO	INA	CSXG080
SKF	FPXG800	FAG	L18WA800	NSK	NBX20325	NTN	KXG080
SSB	RG080XPO	RBC	KG080XPO*RBC				

Brass; snapover separator

1/2" balls

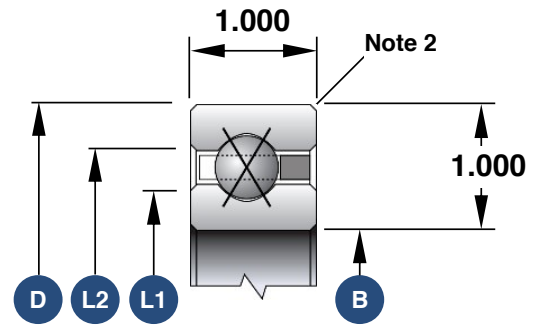

1. Load capacities are not additive
2. The maximum shaft or housing fillet radius that the bearing corners will clear for this series is 0.080"
3. Race Width Tolerance: +0.000 -0.005"

Also Available

Open Angular Contact	SG080AR0
Open Radial Contact	SG080CP0
Open Duplexed (Back-to-Back)	SG080BR0
Open Duplexed (Face-to-Face)	SG080FR0