

SILVERTHIN SG090AR0**9 in Open Type A Thin Section Bearing****Specifications**

Bore (B)	9.000 in
Outside Diameter (D)	11.000 in
Width	1"
Land Diameter (L ₁)	9.742 in
Land Diameter (L ₂)	10.258 in
Land Diameter (L ₃)	10.485 in
Approximate Weight	7.20 lbs
Separator	Brass; one piece pocket separator
Precision Class	ABEC Class 1
Bearing Type	Angular Contact (Type A)
Seals, Shields	None (Open)
Unit System	Inch

Load Capacities

Static Radial Load	18,960 lbf
Dynamic Radial Load	9,075 lbf
Static Thrust Load	54,720 lbf
Dynamic Thrust Load	21,640 lbf

Interchange

Silverthin	SG090AR0	Kaydon	KG090AR0
SKF	FPAG900	FAG	L15WA900
SSB	RG090AR0	RBC	KG090AR0*RBC

Brass; one piece pocket separator

1/2" balls

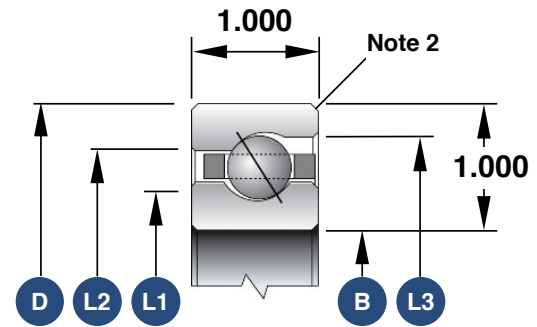

1. Load capacities are not additive
2. The maximum shaft or housing fillet radius that the bearing corners will clear for this series is 0.080"
3. Race Width Tolerance: +0.000 -0.005"

Also Available

Open Radial Contact	SG090CP0
Open 4-Point Contact	SG090XP0
Open Duplexed (Back-to-Back)	SG090BR0
Open Duplexed (Face-to-Face)	SG090FR0