

SILVERTHIN SG090CP0**9 in Open Type C Thin Section Bearing****Specifications**

| | |
|---------------------------------|---------------------------|
| Bore (B) | 9.000 in |
| Outside Diameter (D) | 11.000 in |
| Width | 1" |
| Land Diameter (L ₁) | 9.742 in |
| Land Diameter (L ₂) | 10.258 in |
| Approximate Weight | 7.20 lbs |
| Separator | Brass; snapover separator |
| Precision Class | ABEC Class 1 |
| Bearing Type | Radial Contact (Type C) |
| Seals, Shields | None (Open) |
| Unit System | Inch |

Load Capacities

| | |
|---------------------|------------|
| Static Radial Load | 16,420 lbf |
| Dynamic Radial Load | 8,745 lbf |

Interchange

| | | | | | | | |
|------------|--------------------------|--------|------------------------------|--------|--------------------------|-----|-------------------------|
| Silverthin | SG090CP0 | Kaydon | KG090CP0 | Kaydon | KG090CP0 | INA | CSCG090 |
| SKF | FPCG900 | FAG | L10WA900 | NSK | NBC22825 | NTN | KRG090 |
| SSB | RG090CP0 | RBC | KG090CP0*RBC | | | | |

Brass; snapover separator

1/2" balls

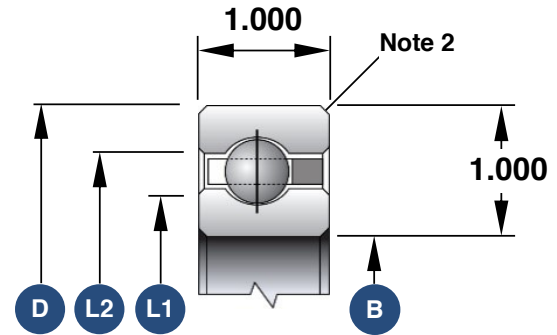

1. Load capacities are not additive
2. The maximum shaft or housing fillet radius that the bearing corners will clear for this series is 0.080"
3. Race Width Tolerance: +0.000 -0.005"

Also Available

| | |
|------------------------------|--------------------------|
| Open Angular Contact | SG090AR0 |
| Open 4-Point Contact | SG090XP0 |
| Open Duplexed (Back-to-Back) | SG090BR0 |
| Open Duplexed (Face-to-Face) | SG090FR0 |