

SILVERTHIN SG100AR0**10 in Open Type A Thin Section Bearing****Specifications**

Bore (B)	10.000 in
Outside Diameter (D)	12.000 in
Width	1"
Land Diameter (L ₁)	10.742 in
Land Diameter (L ₂)	11.258 in
Land Diameter (L ₃)	11.483 in
Approximate Weight	7.90 lbs
Separator	Brass; one piece pocket separator
Precision Class	ABEC Class 1
Bearing Type	Angular Contact (Type A)
Seals, Shields	None (Open)
Unit System	Inch

Load Capacities

Static Radial Load	20,850 lbf
Dynamic Radial Load	9,560 lbf
Static Thrust Load	60,190 lbf
Dynamic Thrust Load	23,060 lbf

Interchange

Silverthin	SG100AR0	Kaydon	KG100AR0
SKF	FPAG1000	FAG	L15WA1000
SSB	RG100AR0	RBC	KG100AR0*RBC

Brass; one piece pocket separator

1/2" balls

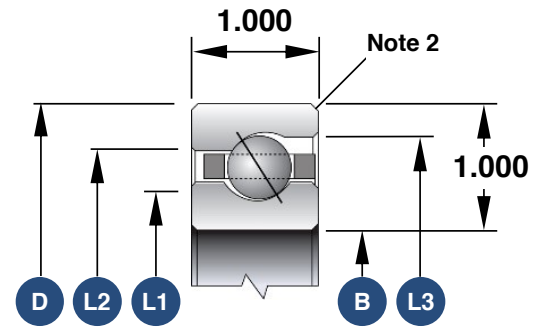

1. Load capacities are not additive
2. The maximum shaft or housing fillet radius that the bearing corners will clear for this series is 0.080"
3. Race Width Tolerance: +0.000 -0.005"

Also Available

Open Radial Contact	SG100CP0
Open 4-Point Contact	SG100XP0
Open Duplexed (Back-to-Back)	SG100BR0
Open Duplexed (Face-to-Face)	SG100FR0