

**SILVERTHIN SG100CP0****10 in Open Type C Thin Section Bearing****Specifications**

Bore (B)	10.000 in
Outside Diameter (D)	12.000 in
Width	1"
Land Diameter (L <sub>1</sub> )	10.742 in
Land Diameter (L <sub>2</sub> )	11.258 in
Approximate Weight	7.90 lbs
Separator	Brass; snapover separator
Precision Class	ABEC Class 1
Bearing Type	Radial Contact (Type C)
Seals, Shields	None (Open)
Unit System	Inch

**Load Capacities**

Static Radial Load	18,060 lbf
Dynamic Radial Load	9,205 lbf

**Interchange**

Silverthin	<a href="#">SG100CP0</a>	Kaydon	<a href="#">KG100CP0</a>	Kaydon	<a href="#">KG100CP0</a>	INA	<a href="#">CSCG100</a>
SKF	<a href="#">FPCG1000</a>	FAG	<a href="#">L10WA1000</a>	NSK	<a href="#">NBC25425</a>	NTN	<a href="#">KRG100</a>
SSB	<a href="#">RG100CP0</a>	RBC	<a href="#">KG100CP0*RBC</a>				

**Brass; snapover separator**

1/2" balls

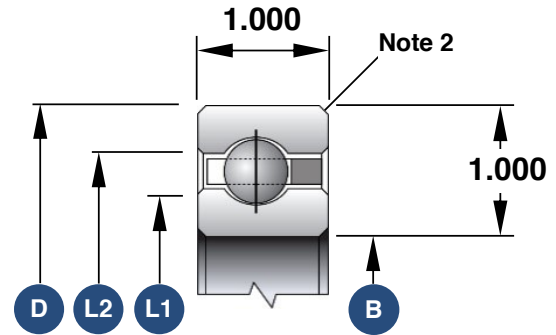

1. Load capacities are not additive
2. The maximum shaft or housing fillet radius that the bearing corners will clear for this series is 0.080"
3. Race Width Tolerance: +0.000 -0.005"

**Also Available**

Open Angular Contact	<a href="#">SG100AR0</a>
Open 4-Point Contact	<a href="#">SG100XP0</a>
Open Duplexed (Back-to-Back)	<a href="#">SG100BR0</a>
Open Duplexed (Face-to-Face)	<a href="#">SG100FR0</a>