

SILVERTHIN SG110AR0**11 in Open Type A Thin Section Bearing****Specifications**

Bore (B)	11.000 in
Outside Diameter (D)	13.000 in
Width	1"
Land Diameter (L ₁)	11.742 in
Land Diameter (L ₂)	12.258 in
Land Diameter (L ₃)	12.481 in
Approximate Weight	8.60 lbs
Separator	Brass; one piece pocket separator
Precision Class	ABEC Class 1
Bearing Type	Angular Contact (Type A)
Seals, Shields	None (Open)
Unit System	Inch

Load Capacities

Static Radial Load	22,750 lbf
Dynamic Radial Load	10,025 lbf
Static Thrust Load	65,660 lbf
Dynamic Thrust Load	24,440 lbf

Interchange

Silverthin	SG110AR0	Kaydon	KG110AR0
SKF	FPAG1100	FAG	L15WA1100
SSB	RG110AR0	RBC	KG110AR0*RBC

Brass; one piece pocket separator

1/2" balls

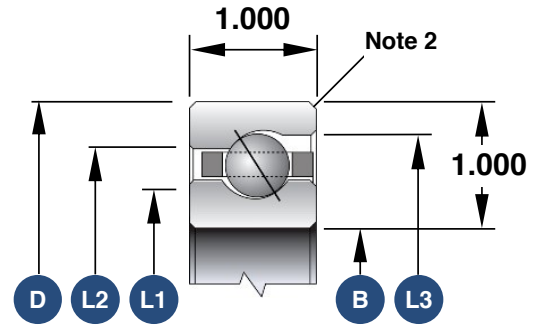

1. Load capacities are not additive
2. The maximum shaft or housing fillet radius that the bearing corners will clear for this series is 0.080"
3. Race Width Tolerance: +0.000 -0.005"

Also Available

Open Radial Contact	SG110CP0
Open 4-Point Contact	SG110XP0
Open Duplexed (Back-to-Back)	SG110BR0
Open Duplexed (Face-to-Face)	SG110FR0