

**SILVERTHIN SG110CP0****11 in Open Type C Thin Section Bearing****Specifications**

Bore (B)	11.000 in
Outside Diameter (D)	13.000 in
Width	1"
Land Diameter (L <sub>1</sub> )	11.742 in
Land Diameter (L <sub>2</sub> )	12.258 in
Approximate Weight	8.60 lbs
Separator	Brass; snapover separator
Precision Class	ABEC Class 1
Bearing Type	Radial Contact (Type C)
Seals, Shields	None (Open)
Unit System	Inch

**Load Capacities**

Static Radial Load	19,700 lbf
Dynamic Radial Load	9,650 lbf

**Interchange**

Silverthin	<b>SG110CP0</b>	Kaydon	<b>KG110CP0</b>	Kaydon	<b>KG110CP0</b>	INA	<b>CSCG110</b>
SKF	<b>FPCG1100</b>	FAG	<b>L10WA1100</b>	NSK	<b>NBC27925</b>	NTN	<b>KRG110</b>
SSB	<b>RG110CP0</b>	RBC	<b>KG110CP0*RBC</b>				

**Brass; snapover separator**

1/2" balls

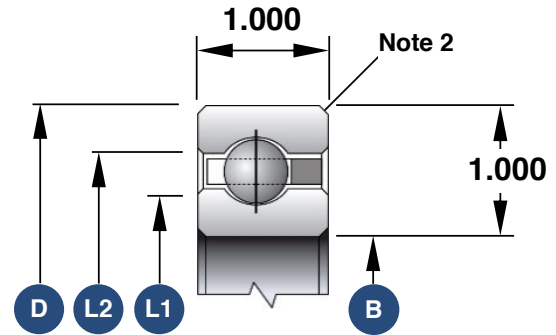

1. Load capacities are not additive
2. The maximum shaft or housing fillet radius that the bearing corners will clear for this series is 0.080"
3. Race Width Tolerance: +0.000 -0.005"

**Also Available**

Open Angular Contact	<b>SG110AR0</b>
Open 4-Point Contact	<b>SG110XP0</b>
Open Duplexed (Back-to-Back)	<b>SG110BR0</b>
Open Duplexed (Face-to-Face)	<b>SG110FR0</b>