

SILVERTHIN SG110XP0**11 in Open Type X Thin Section Bearing****Specifications**

Bore (B)	11.000 in
Outside Diameter (D)	13.000 in
Width	1"
Land Diameter (L ₁)	11.742 in
Land Diameter (L ₂)	12.258 in
Approximate Weight	8.60 lbs
Separator	Brass; snapover separator
Precision Class	ABEC Class 1
Bearing Type	4-Point Contact (Type X)
Seals, Shields	None (Open)
Unit System	Inch

Load Capacities

Static Radial Load	19,700 lbf
Dynamic Radial Load	12,740 lbf
Static Thrust Load	49,250 lbf
Dynamic Thrust Load	20,180 lbf
Static Moment Load	118,200 in-lbs
Dynamic Moment Load	57,345 in-lbs

Interchange

Silverthin	SG110XP0	Kaydon	KG110XP0	Kaydon	KG110XP0	INA	CSXG110
SKF	FPXG1100	FAG	L18WA1100	NSK	NBX27925	NTN	KXG110
SSB	RG110XP0	RBC	KG110XP0*RBC				

Brass; snapover separator

1/2" balls

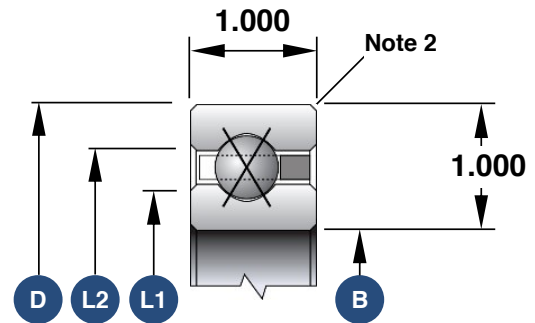

1. Load capacities are not additive
2. The maximum shaft or housing fillet radius that the bearing corners will clear for this series is 0.080"
3. Race Width Tolerance: +0.000 -0.005"

Also Available

Open Angular Contact	SG110AR0
Open Radial Contact	SG110CP0
Open Duplexed (Back-to-Back)	SG110BR0
Open Duplexed (Face-to-Face)	SG110FR0