

SILVERTHIN SG120AR0**12 in Open Type A Thin Section Bearing****Specifications**

Bore (B)	12.000 in
Outside Diameter (D)	14.000 in
Width	1"
Land Diameter (L ₁)	12.742 in
Land Diameter (L ₂)	13.258 in
Land Diameter (L ₃)	13.481 in
Approximate Weight	9.30 lbs
Separator	Brass; one piece pocket separator
Precision Class	ABEC Class 1
Bearing Type	Angular Contact (Type A)
Seals, Shields	None (Open)
Unit System	Inch

Load Capacities

Static Radial Load	24,640 lbf
Dynamic Radial Load	10,480 lbf
Static Thrust Load	71,140 lbf
Dynamic Thrust Load	25,780 lbf

Interchange

Silverthin	SG120AR0	Kaydon	KG120AR0
SKF	FPAG1200	FAG	L15WA1200
SSB	RG120AR0	RBC	KG120AR0*RBC

Brass; one piece pocket separator

1/2" balls

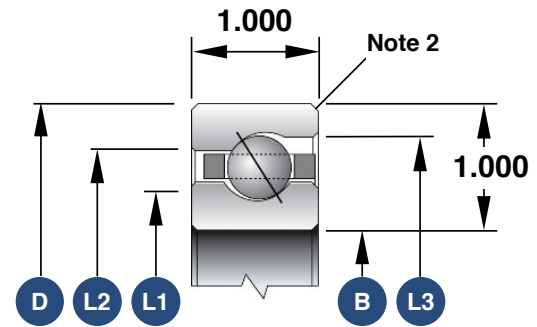

1. Load capacities are not additive
2. The maximum shaft or housing fillet radius that the bearing corners will clear for this series is 0.080"
3. Race Width Tolerance: +0.000 -0.005"

Also Available

Open Radial Contact	SG120CP0
Open 4-Point Contact	SG120XP0
Open Duplexed (Back-to-Back)	SG120BR0
Open Duplexed (Face-to-Face)	SG120FR0