

**SILVERTHIN SG120CP0****12 in Open Type C Thin Section Bearing****Specifications**

Bore (B)	12.000 in
Outside Diameter (D)	14.000 in
Width	1"
Land Diameter (L <sub>1</sub> )	12.742 in
Land Diameter (L <sub>2</sub> )	13.258 in
Approximate Weight	9.30 lbs
Separator	Brass; snapover separator
Precision Class	ABEC Class 1
Bearing Type	Radial Contact (Type C)
Seals, Shields	None (Open)
Unit System	Inch

**Load Capacities**

Static Radial Load	21,340 lbf
Dynamic Radial Load	10,075 lbf

**Interchange**

Silverthin	<a href="#">SG120CP0</a>	Kaydon	<a href="#">KG120CP0</a>	Kaydon	<a href="#">KG120CP0</a>	INA	<a href="#">CSCG120</a>
SKF	<a href="#">FPCG1200</a>	FAG	<a href="#">L10WA1200</a>	NSK	<a href="#">NBC30425</a>	NTN	<a href="#">KRG120</a>
SSB	<a href="#">RG120CP0</a>	RBC	<a href="#">KG120CP0*RBC</a>				

**Brass; snapover separator**

1/2" balls

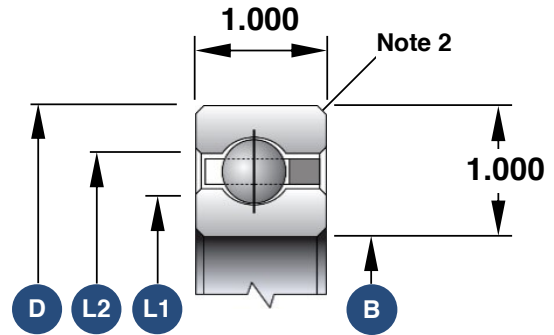

1. Load capacities are not additive
2. The maximum shaft or housing fillet radius that the bearing corners will clear for this series is 0.080"
3. Race Width Tolerance: +0.000 -0.005"

**Also Available**

Open Angular Contact	<a href="#">SG120AR0</a>
Open 4-Point Contact	<a href="#">SG120XP0</a>
Open Duplexed (Back-to-Back)	<a href="#">SG120BR0</a>
Open Duplexed (Face-to-Face)	<a href="#">SG120FR0</a>