

SILVERTHIN SG120XP0**12 in Open Type X Thin Section Bearing****Specifications**

Bore (B)	12.000 in
Outside Diameter (D)	14.000 in
Width	1"
Land Diameter (L ₁)	12.742 in
Land Diameter (L ₂)	13.258 in
Approximate Weight	9.30 lbs
Separator	Brass; snapover separator
Precision Class	ABEC Class 1
Bearing Type	4-Point Contact (Type X)
Seals, Shields	None (Open)
Unit System	Inch

Load Capacities

Static Radial Load	21,340 lbf
Dynamic Radial Load	13,315 lbf
Static Thrust Load	53,350 lbf
Dynamic Thrust Load	21,280 lbf
Static Moment Load	138,700 in-lbs
Dynamic Moment Load	64,935 in-lbs

Interchange

Silverthin	SG120XP0	Kaydon	KG120XP0	Kaydon	KG120XP0	INA	CSXG120
SKF	FPXG1200	FAG	L18WA1200	NSK	NBX30425	NTN	KXG120
SSB	RG120XP0	RBC	KG120XP0*RBC				

Brass; snapover separator

1/2" balls

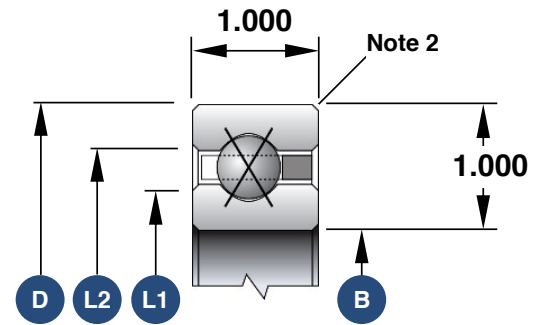

1. Load capacities are not additive
2. The maximum shaft or housing fillet radius that the bearing corners will clear for this series is 0.080"
3. Race Width Tolerance: +0.000 -0.005"

Also Available

Open Angular Contact	SG120AR0
Open Radial Contact	SG120CP0
Open Duplexed (Back-to-Back)	SG120BR0
Open Duplexed (Face-to-Face)	SG120FR0