

SILVERTHIN SG140CP0**14 in Open Type C Thin Section Bearing****Specifications**

Bore (B)	14.000 in
Outside Diameter (D)	16.000 in
Width	1"
Land Diameter (L ₁)	14.742 in
Land Diameter (L ₂)	15.258 in
Approximate Weight	10.80 lbs
Separator	Brass; snapover separator
Precision Class	ABEC Class 1
Bearing Type	Radial Contact (Type C)
Seals, Shields	None (Open)
Unit System	Inch

Load Capacities

Static Radial Load	24,620 lbf
Dynamic Radial Load	10,885 lbf

Interchange

Silverthin	SG140CP0	Kaydon	KG140CP0	Kaydon	KG140CP0	INA	CSCG140
SKF	FPCG1400	FAG	L10WA1400	NSK	NBC35525	NTN	KRG140
SSB	RG140CP0	RBC	KG140CP0*RBC				

Brass; snapover separator

1/2" balls

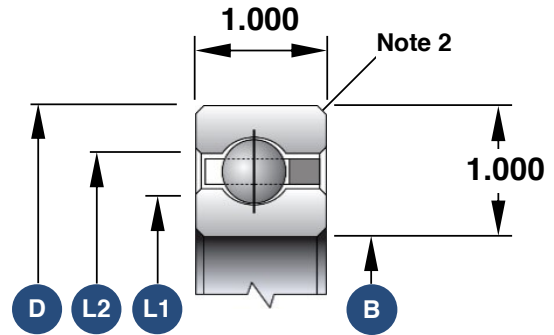

1. Load capacities are not additive
2. The maximum shaft or housing fillet radius that the bearing corners will clear for this series is 0.080"
3. Race Width Tolerance: +0.000 -0.005"

Also Available

Open Angular Contact	SG140AR0
Open 4-Point Contact	SG140XP0
Open Duplexed (Back-to-Back)	SG140BR0
Open Duplexed (Face-to-Face)	SG140FR0