

SILVERTHIN SG140XP0**14 in Open Type X Thin Section Bearing****Specifications**

Bore (B)	14.000 in
Outside Diameter (D)	16.000 in
Width	1"
Land Diameter (L ₁)	14.742 in
Land Diameter (L ₂)	15.258 in
Approximate Weight	10.80 lbs
Separator	Brass; snapover separator
Precision Class	ABEC Class 1
Bearing Type	4-Point Contact (Type X)
Seals, Shields	None (Open)
Unit System	Inch

Load Capacities

Static Radial Load	24,620 lbf
Dynamic Radial Load	14,405 lbf
Static Thrust Load	61,560 lbf
Dynamic Thrust Load	23,410 lbf
Static Moment Load	184,700 in-lbs
Dynamic Moment Load	81,055 in-lbs

Interchange

Silverthin	SG140XP0	Kaydon	KG140XP0	Kaydon	KG140XP0	INA	CSXG140
SKF	FPXG1400	FAG	L18WA1400	NSK	NBX35525	NTN	KXF140
SSB	RG140XP0	RBC	KG140XP0*RBC				

Brass; snapover separator

1/2" balls

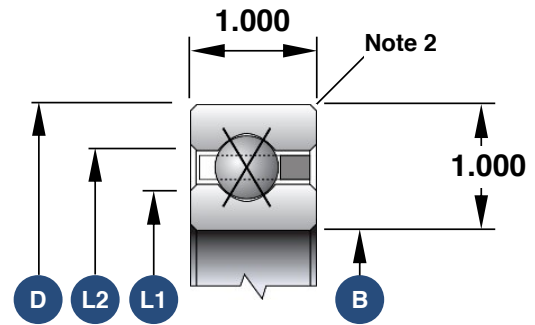

1. Load capacities are not additive
2. The maximum shaft or housing fillet radius that the bearing corners will clear for this series is 0.080"
3. Race Width Tolerance: +0.000 -0.005"

Also Available

Open Angular Contact	SG140AR0
Open Radial Contact	SG140CP0
Open Duplexed (Back-to-Back)	SG140BR0
Open Duplexed (Face-to-Face)	SG140FR0