

**SILVERTHIN SG160AR0****16 in Open Type A Thin Section Bearing****Specifications**

Bore (B)	16.000 in
Outside Diameter (D)	18.000 in
Width	1"
Land Diameter (L <sub>1</sub> )	16.742 in
Land Diameter (L <sub>2</sub> )	17.258 in
Land Diameter (L <sub>3</sub> )	17.474 in
Approximate Weight	12.30 lbs
Separator	Brass; one piece pocket separator
Precision Class	ABEC Class 1
Bearing Type	Angular Contact (Type A)
Seals, Shields	None (Open)
Unit System	Inch

**Load Capacities**

Static Radial Load	32,220 lbf
Dynamic Radial Load	12,140 lbf
Static Thrust Load	93,020 lbf
Dynamic Thrust Load	30,830 lbf

**Interchange**

Silverthin	<b>SG160AR0</b>	Kaydon	<b>KG160AR0</b>
SKF	<b>FPAG1600</b>	FAG	<b>L15WA1600</b>
SSB	<b>RG160AR0</b>	RBC	<b>KG160AR0*RBC</b>

**Brass; one piece pocket separator**

1/2" balls

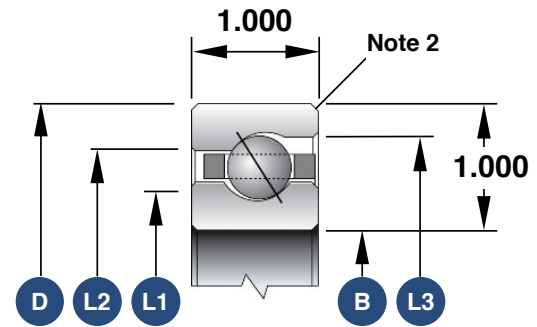

1. Load capacities are not additive
2. The maximum shaft or housing fillet radius that the bearing corners will clear for this series is 0.080"
3. Race Width Tolerance: +0.000 -0.005"

**Also Available**

Open Radial Contact	<b>SG160CP0</b>
Open 4-Point Contact	<b>SG160XP0</b>
Open Duplexed (Back-to-Back)	<b>SG160BR0</b>
Open Duplexed (Face-to-Face)	<b>SG160FR0</b>