

SILVERTHIN SG160XPO**16 in Open Type X Thin Section Bearing****Specifications**

Bore (B)	16.000 in
Outside Diameter (D)	18.000 in
Width	1"
Land Diameter (L ₁)	16.742 in
Land Diameter (L ₂)	17.258 in
Approximate Weight	12.30 lbs
Separator	Brass; snapover separator
Precision Class	ABEC Class 1
Bearing Type	4-Point Contact (Type X)
Seals, Shields	None (Open)
Unit System	Inch

Load Capacities

Static Radial Load	27,910 lbf
Dynamic Radial Load	15,425 lbf
Static Thrust Load	69,770 lbf
Dynamic Thrust Load	25,450 lbf
Static Moment Load	237,200 in-lbs
Dynamic Moment Load	98,375 in-lbs

Interchange

Silverthin	SG160XPO	Kaydon	KG160XPO	Kaydon	KG160XPO	INA	CSXG160
SKF	FPXG1600	FAG	L18WA1600	NSK	NBX40625	NTN	KXG160
SSB	RG160XPO	RBC	KG160XPO*RBC				

Brass; snapover separator

1/2" balls

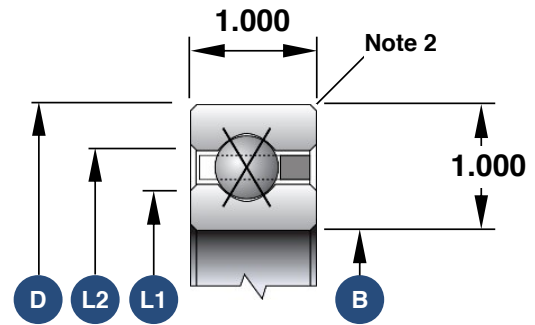

1. Load capacities are not additive
2. The maximum shaft or housing fillet radius that the bearing corners will clear for this series is 0.080"
3. Race Width Tolerance: +0.000 -0.005"

Also Available

Open Angular Contact	SG160AR0
Open Radial Contact	SG160CP0
Open Duplexed (Back-to-Back)	SG160BR0
Open Duplexed (Face-to-Face)	SG160FR0