

SILVERTHIN SG180CP0**18 in Open Type C Thin Section Bearing****Specifications**

Bore (B)	18.000 in
Outside Diameter (D)	20.000 in
Width	1"
Land Diameter (L ₁)	18.742 in
Land Diameter (L ₂)	19.258 in
Approximate Weight	13.70 lbs
Separator	Brass; snapover separator
Precision Class	ABEC Class 1
Bearing Type	Radial Contact (Type C)
Seals, Shields	None (Open)
Unit System	Inch

Load Capacities

Static Radial Load	31,190 lbf
Dynamic Radial Load	12,365 lbf

Interchange

Silverthin	SG180CP0	Kaydon	KG180CP0	Kaydon	KG180CP0	INA	CSCG180
SKF	FPCG1800	FAG	L10WA1800	NSK	NBC45725	NTN	KRG180
SSB	RG180CP0	RBC	KG180CP0*RBC				

Brass; snapover separator

1/2" balls

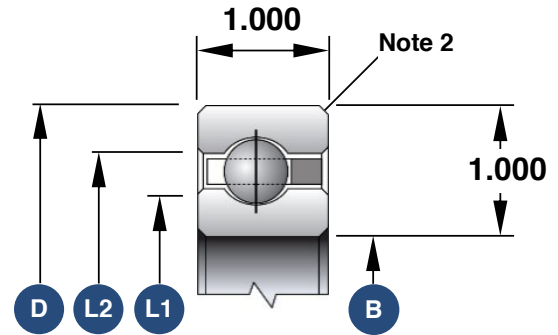

1. Load capacities are not additive
2. The maximum shaft or housing fillet radius that the bearing corners will clear for this series is 0.080"
3. Race Width Tolerance: +0.000 -0.005"

Also Available

Open Angular Contact	SG180AR0
Open 4-Point Contact	SG180XP0
Open Duplexed (Back-to-Back)	SG180BR0
Open Duplexed (Face-to-Face)	SG180FR0