

**SILVERTHIN SG180XP0****18 in Open Type X Thin Section Bearing****Specifications**

Bore (B)	18.000 in
Outside Diameter (D)	20.000 in
Width	1"
Land Diameter (L <sub>1</sub> )	18.742 in
Land Diameter (L <sub>2</sub> )	19.258 in
Approximate Weight	13.70 lbs
Separator	Brass; snapover separator
Precision Class	ABEC Class 1
Bearing Type	4-Point Contact (Type X)
Seals, Shields	None (Open)
Unit System	Inch

**Load Capacities**

Static Radial Load	31,190 lbf
Dynamic Radial Load	16,385 lbf
Static Thrust Load	77,980 lbf
Dynamic Thrust Load	27,410 lbf
Static Moment Load	296,300 in-lbs
Dynamic Moment Load	116,795 in-lbs

**Interchange**

Silverthin	<b>SG180XP0</b>	Kaydon	<b>KG180XP0</b>	Kaydon	<b>KG180XP0</b>	INA	<b>CSXG180</b>
SKF	<b>FPXG1800</b>	FAG	<b>L18WA1800</b>	NSK	<b>NBX45725</b>	NTN	<b>KXG180</b>
SSB	<b>RG180XP0</b>	RBC	<b>KG180XP0*RBC</b>				

**Brass; snapover separator**

1/2" balls

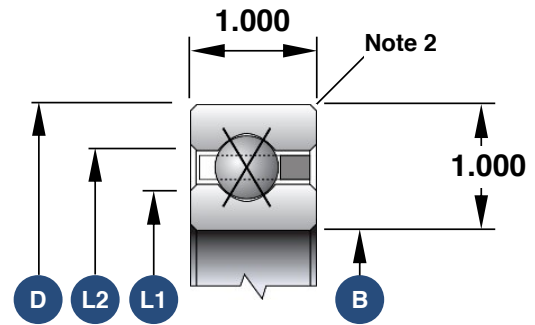

1. Load capacities are not additive
2. The maximum shaft or housing fillet radius that the bearing corners will clear for this series is 0.080"
3. Race Width Tolerance: +0.000 -0.005"

**Also Available**

Open Angular Contact	<b>SG180AR0</b>
Open Radial Contact	<b>SG180CP0</b>
Open Duplexed (Back-to-Back)	<b>SG180BR0</b>
Open Duplexed (Face-to-Face)	<b>SG180FR0</b>