

SILVERTHIN SG200AR0**20 in Open Type A Thin Section Bearing****Specifications**

Bore (B)	20.000 in
Outside Diameter (D)	22.000 in
Width	1"
Land Diameter (L ₁)	20.742 in
Land Diameter (L ₂)	21.258 in
Land Diameter (L ₃)	21.468 in
Approximate Weight	15.80 lbs
Separator	Brass; one piece pocket separator
Precision Class	ABEC Class 1
Bearing Type	Angular Contact (Type A)
Seals, Shields	None (Open)
Unit System	Inch

Load Capacities

Static Radial Load	39,810 lbf
Dynamic Radial Load	13,610 lbf
Static Thrust Load	114,900 lbf
Dynamic Thrust Load	35,490 lbf

Interchange

Silverthin	SG200AR0	Kaydon	KG200AR0
SKF	FPAG2000	FAG	L15WA2000
SSB	RG200AR0	RBC	KG200AR0*RBC

Brass; one piece pocket separator

1/2" balls

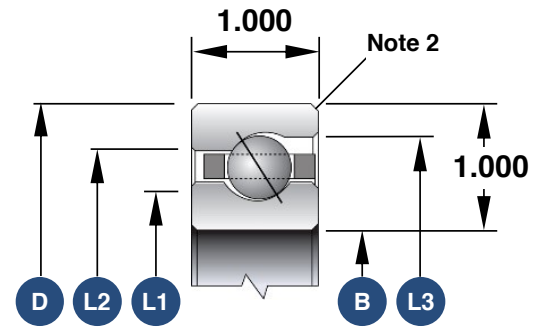

1. Load capacities are not additive
2. The maximum shaft or housing fillet radius that the bearing corners will clear for this series is 0.080"
3. Race Width Tolerance: +0.000 -0.005"

Also Available

Open Radial Contact	SG200CP0
Open 4-Point Contact	SG200XP0
Open Duplexed (Back-to-Back)	SG200BR0
Open Duplexed (Face-to-Face)	SG200FR0