

SILVERTHIN SG200XPO**20 in Open Type X Thin Section Bearing****Specifications**

Bore (B)	20.000 in
Outside Diameter (D)	22.000 in
Width	1"
Land Diameter (L ₁)	20.742 in
Land Diameter (L ₂)	21.258 in
Approximate Weight	15.80 lbs
Separator	Brass; snapover separator
Precision Class	ABEC Class 1
Bearing Type	4-Point Contact (Type X)
Seals, Shields	None (Open)
Unit System	Inch

Load Capacities

Static Radial Load	34,470 lbf
Dynamic Radial Load	17,295 lbf
Static Thrust Load	86,180 lbf
Dynamic Thrust Load	29,300 lbf
Static Moment Load	362,000 in-lbs
Dynamic Moment Load	136,240 in-lbs

Interchange

Silverthin	SG200XPO	Kaydon	KG200XPO	Kaydon	KG200XPO	INA	CSXG200
SKF	FPXG2000	FAG	L18WA2000	NSK	NBX50825	NTN	KXG200
SSB	RG200XPO	RBC	KG200XPO*RBC				

Brass; snapover separator

1/2" balls

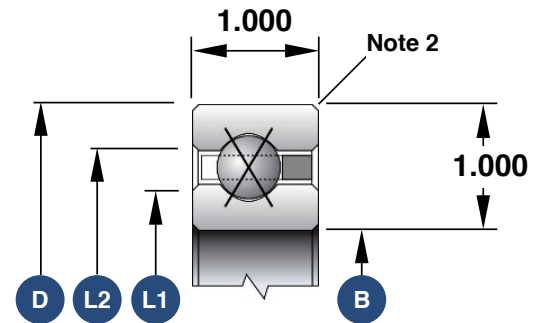

1. Load capacities are not additive
2. The maximum shaft or housing fillet radius that the bearing corners will clear for this series is 0.080"
3. Race Width Tolerance: +0.000 -0.005"

Also Available

Open Angular Contact	SG200AR0
Open Radial Contact	SG200CP0
Open Duplexed (Back-to-Back)	SG200BR0
Open Duplexed (Face-to-Face)	SG200FR0