

SILVERTHIN SG250AR0**25 in Open Type A Thin Section Bearing****Specifications**

Bore (B)	25.000 in
Outside Diameter (D)	27.000 in
Width	1"
Land Diameter (L ₁)	25.742 in
Land Diameter (L ₂)	26.258 in
Land Diameter (L ₃)	26.461 in
Approximate Weight	19.50 lbs
Separator	Brass; one piece pocket separator
Precision Class	ABEC Class 1
Bearing Type	Angular Contact (Type A)
Seals, Shields	None (Open)
Unit System	Inch

Load Capacities

Static Radial Load	49,280 lbf
Dynamic Radial Load	15,240 lbf
Static Thrust Load	142,300 lbf
Dynamic Thrust Load	40,920 lbf

Interchange

Silverthin	SG250AR0	Kaydon	KG250AR0
SKF	FPAG2500	FAG	L15WA2500
SSB	RG250AR0	RBC	KG250AR0*RBC

Brass; one piece pocket separator

1/2" balls

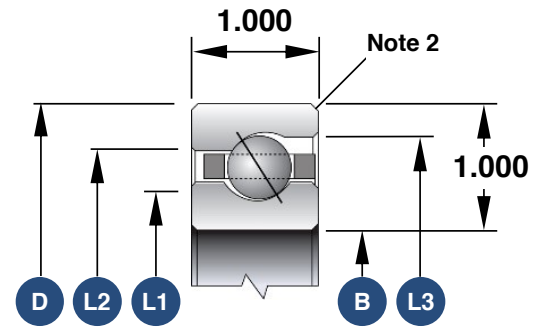

1. Load capacities are not additive
2. The maximum shaft or housing fillet radius that the bearing corners will clear for this series is 0.080"
3. Race Width Tolerance: +0.000 -0.005"

Also Available

Open Radial Contact	SG250CP0
Open 4-Point Contact	SG250XP0
Open Duplexed (Back-to-Back)	SG250BR0
Open Duplexed (Face-to-Face)	SG250FR0