

SILVERTHIN SG250CP0**25 in Open Type C Thin Section Bearing****Specifications**

Bore (B)	25.000 in
Outside Diameter (D)	27.000 in
Width	1"
Land Diameter (L ₁)	25.742 in
Land Diameter (L ₂)	26.258 in
Approximate Weight	19.50 lbs
Separator	Brass; snapover separator
Precision Class	ABEC Class 1
Bearing Type	Radial Contact (Type C)
Seals, Shields	None (Open)
Unit System	Inch

Load Capacities

Static Radial Load	42,680 lbf
Dynamic Radial Load	14,595 lbf

Interchange

Silverthin	SG250CP0	Kaydon	KG250CP0	Kaydon	KG250CP0	INA	CSCG250
SKF	FPCG2500	FAG	L10WA2500	NSK	NBC63525	NTN	KRG220
SSB	RG250CP0	RBC	KG250CP0*RBC				

Brass; snapover separator

1/2" balls

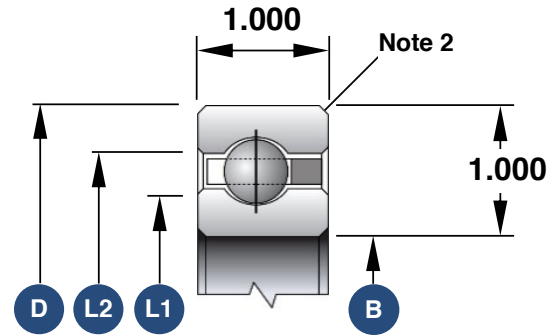

1. Load capacities are not additive
2. The maximum shaft or housing fillet radius that the bearing corners will clear for this series is 0.080"
3. Race Width Tolerance: +0.000 -0.005"

Also Available

Open Angular Contact	SG250AR0
Open 4-Point Contact	SG250XP0
Open Duplexed (Back-to-Back)	SG250BR0
Open Duplexed (Face-to-Face)	SG250FR0