

SILVERTHIN SG250XP0**25 in Open Type X Thin Section Bearing****Specifications**

Bore (B)	25.000 in
Outside Diameter (D)	27.000 in
Width	1"
Land Diameter (L ₁)	25.742 in
Land Diameter (L ₂)	26.258 in
Approximate Weight	19.50 lbs
Separator	Brass; snapover separator
Precision Class	ABEC Class 1
Bearing Type	4-Point Contact (Type X)
Seals, Shields	None (Open)
Unit System	Inch

Load Capacities

Static Radial Load	42,680 lbf
Dynamic Radial Load	19,360 lbf
Static Thrust Load	106,700 lbf
Dynamic Thrust Load	33,780 lbf
Static Moment Load	554,900 in-lbs
Dynamic Moment Load	188,840 in-lbs

Interchange

Silverthin	SG250XP0	Kaydon	KG250XP0	Kaydon	KG250XP0	INA	CSXG250
SKF	FPXG2500	FAG	L18WA2500	NSK	NBX63525	NTN	KXG220
SSB	RG250XP0	RBC	KG250XP0*RBC				

Brass; snapover separator

1/2" balls

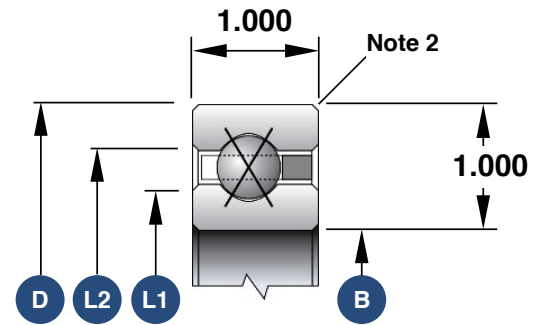

1. Load capacities are not additive
2. The maximum shaft or housing fillet radius that the bearing corners will clear for this series is 0.080"
3. Race Width Tolerance: +0.000 -0.005"

Also Available

Open Angular Contact	SG250AR0
Open Radial Contact	SG250CP0
Open Duplexed (Back-to-Back)	SG250BR0
Open Duplexed (Face-to-Face)	SG250FR0