

SILVERTHIN SG300CP0**30 in Open Type C Thin Section Bearing****Specifications**

Bore (B)	30.000 in
Outside Diameter (D)	32.000 in
Width	1"
Land Diameter (L ₁)	30.742 in
Land Diameter (L ₂)	31.258 in
Approximate Weight	23.30 lbs
Separator	Brass; snapover separator
Precision Class	ABEC Class 1
Bearing Type	Radial Contact (Type C)
Seals, Shields	None (Open)
Unit System	Inch

Load Capacities

Static Radial Load	50,890 lbf
Dynamic Radial Load	15,965 lbf

Interchange

Silverthin	SG300CP0	Kaydon	KG300CP0	Kaydon	KG300CP0	INA	CSCG300
SKF	FPCG3000	FAG	L10WA3000	NSK	NBC76225	NTN	KRG240
SSB	RG300CP0	RBC	KG300CP0*RBC				

Brass; snapover separator

1/2" balls

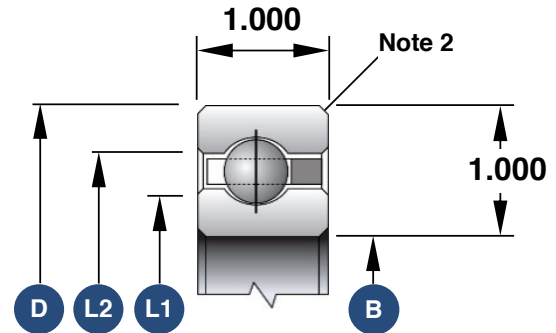

1. Load capacities are not additive
2. The maximum shaft or housing fillet radius that the bearing corners will clear for this series is 0.080"
3. Race Width Tolerance: +0.000 -0.005"

Also Available

Open Angular Contact	SG300AR0
Open 4-Point Contact	SG300XP0
Open Duplexed (Back-to-Back)	SG300BR0
Open Duplexed (Face-to-Face)	SG300FR0