

SILVERTHIN SG300XPO**30 in Open Type X Thin Section Bearing****Specifications**

Bore (B)	30.000 in
Outside Diameter (D)	32.000 in
Width	1"
Land Diameter (L ₁)	30.742 in
Land Diameter (L ₂)	31.258 in
Approximate Weight	23.30 lbs
Separator	Brass; snapover separator
Precision Class	ABEC Class 1
Bearing Type	4-Point Contact (Type X)
Seals, Shields	None (Open)
Unit System	Inch

Load Capacities

Static Radial Load	50,890 lbf
Dynamic Radial Load	21,200 lbf
Static Thrust Load	127,200 lbf
Dynamic Thrust Load	37,980 lbf
Static Moment Load	788,800 in-lbs
Dynamic Moment Load	246,540 in-lbs

Interchange

Silverthin	SG300XPO	Kaydon	KG300XPO	Kaydon	KG300XPO	INA	CSXG300
SKF	FPXG3000	FAG	L18WA3000	NSK	NBX76225	NTN	KXG240
SSB	RG300XPO	RBC	KG300XPO*RBC				

Brass; snapover separator

1/2" balls

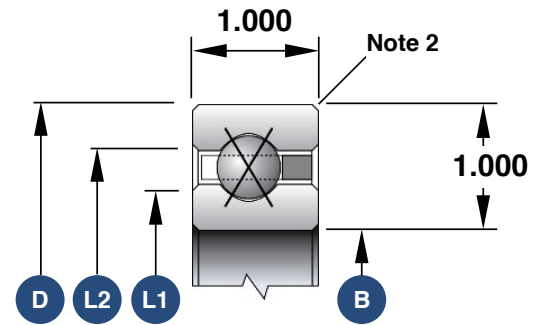

1. Load capacities are not additive
2. The maximum shaft or housing fillet radius that the bearing corners will clear for this series is 0.080"
3. Race Width Tolerance: +0.000 -0.005"

Also Available

Open Angular Contact	SG300AR0
Open Radial Contact	SG300CP0
Open Duplexed (Back-to-Back)	SG300BR0
Open Duplexed (Face-to-Face)	SG300FR0