

**SILVERTHIN SG350AR0****35 in Open Type A Thin Section Bearing****Specifications**

Bore (B)	35.000 in
Outside Diameter (D)	37.000 in
Width	1"
Land Diameter (L <sub>1</sub> )	35.742 in
Land Diameter (L <sub>2</sub> )	36.258 in
Land Diameter (L <sub>3</sub> )	36.440 in
Approximate Weight	27.10 lbs
Separator	Brass; one piece pocket separator
Precision Class	ABEC Class 1
Bearing Type	Angular Contact (Type A)
Seals, Shields	None (Open)
Unit System	Inch

**Load Capacities**

Static Radial Load	68,240 lbf
Dynamic Radial Load	17,980 lbf
Static Thrust Load	197,000 lbf
Dynamic Thrust Load	50,840 lbf

**Interchange**

Silverthin	<b>SG350AR0</b>	Kaydon	<b>KG350AR0</b>
SKF	<b>FPAG3500</b>	FAG	<b>L15WA3500</b>
SSB	<b>RG350AR0</b>	RBC	<b>KG350AR0*RBC</b>

**Brass; one piece pocket separator**

1/2" balls

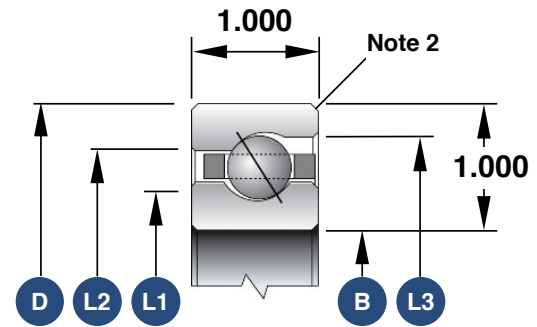

1. Load capacities are not additive
2. The maximum shaft or housing fillet radius that the bearing corners will clear for this series is 0.080"
3. Race Width Tolerance: +0.000 -0.005"

**Also Available**

Open Radial Contact	<b>SG350CP0</b>
Open 4-Point Contact	<b>SG350XP0</b>
Open Duplexed (Back-to-Back)	<b>SG350BR0</b>
Open Duplexed (Face-to-Face)	<b>SG350FR0</b>