

SILVERTHIN SG350CP0**35 in Open Type C Thin Section Bearing****Specifications**

Bore (B)	35.000 in
Outside Diameter (D)	37.000 in
Width	1"
Land Diameter (L ₁)	35.742 in
Land Diameter (L ₂)	36.258 in
Approximate Weight	27.10 lbs
Separator	Brass; snapover separator
Precision Class	ABEC Class 1
Bearing Type	Radial Contact (Type C)
Seals, Shields	None (Open)
Unit System	Inch

Load Capacities

Static Radial Load	59,100 lbf
Dynamic Radial Load	17,195 lbf

Interchange

Silverthin	SG350CP0	Kaydon	KG350CP0	Kaydon	KG350CP0	INA	CSCG350
SKF	FPCG3500	FAG	L10WA3500	NSK	NBC88925	NTN	KRG260
SSB	RG350CP0	RBC	KG350CP0*RBC				

Brass; snapover separator

1/2" balls

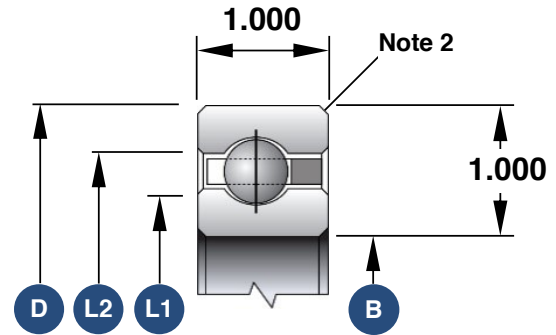

1. Load capacities are not additive
2. The maximum shaft or housing fillet radius that the bearing corners will clear for this series is 0.080"
3. Race Width Tolerance: +0.000 -0.005"

Also Available

Open Angular Contact	SG350AR0
Open 4-Point Contact	SG350XP0
Open Duplexed (Back-to-Back)	SG350BR0
Open Duplexed (Face-to-Face)	SG350FR0