

**SILVERTHIN SG350XPO****35 in Open Type X Thin Section Bearing****Specifications**

Bore (B)	35.000 in
Outside Diameter (D)	37.000 in
Width	1"
Land Diameter (L <sub>1</sub> )	35.742 in
Land Diameter (L <sub>2</sub> )	36.258 in
Approximate Weight	27.10 lbs
Separator	Brass; snapover separator
Precision Class	ABEC Class 1
Bearing Type	4-Point Contact (Type X)
Seals, Shields	None (Open)
Unit System	Inch

**Load Capacities**

Static Radial Load	59,100 lbf
Dynamic Radial Load	22,845 lbf
Static Thrust Load	147,700 lbf
Dynamic Thrust Load	41,970 lbf
Static Moment Load	1,064,000 in-lbs
Dynamic Moment Load	308,525 in-lbs

**Interchange**

Silverthin	<a href="#">SG350XPO</a>	Kaydon	<a href="#">KG350XPO</a>	Kaydon	<a href="#">KG350XPO</a>	INA	<a href="#">CSXG350</a>
SKF	<a href="#">FPXG3500</a>	FAG	<a href="#">L18WA3500</a>	NSK	<a href="#">NBX88925</a>	NTN	<a href="#">KXG260</a>
SSB	<a href="#">RG350XPO</a>	RBC	<a href="#">KG350XPO*RBC</a>				

**Brass; snapover separator**

1/2" balls

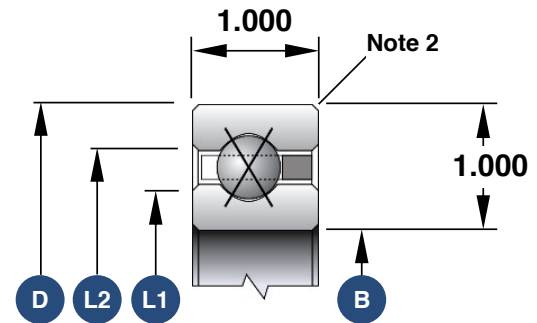

1. Load capacities are not additive
2. The maximum shaft or housing fillet radius that the bearing corners will clear for this series is 0.080"
3. Race Width Tolerance: +0.000 -0.005"

**Also Available**

Open Angular Contact	<a href="#">SG350AR0</a>
Open Radial Contact	<a href="#">SG350CP0</a>
Open Duplexed (Back-to-Back)	<a href="#">SG350BR0</a>
Open Duplexed (Face-to-Face)	<a href="#">SG350FR0</a>