

SILVERTHIN SM09013ARO

90 mm Open Type A Thin Section Bearing

Specifications

Bore (B)	90.000 mm
Outside Diameter (D)	116.000 mm
Width	13mm
Land Diameter (L ₁)	99.700 mm
Land Diameter (L ₂)	106.300 mm
Land Diameter (L ₃)	109.600 mm
Approximate Weight	0.29 kg
Separator	Brass; one piece pocket separator
Precision Class	ABEC Class 1
Bearing Type	Angular Contact (Type A)
Seals, Shields	None (Open)
Unit System	Metric

Load Capacities

Static Radial Load	17,570 n
Dynamic Radial Load	9,450 n
Static Thrust Load	50,705 n
Dynamic Thrust Load	21,485 n

Interchange

Silverthin	SM09013ARO	Kaydon	K09013ARO	Kaydon	K09013ARO
------------	------------	--------	-----------	--------	-----------

Brass; one piece pocket separator

1/4" balls

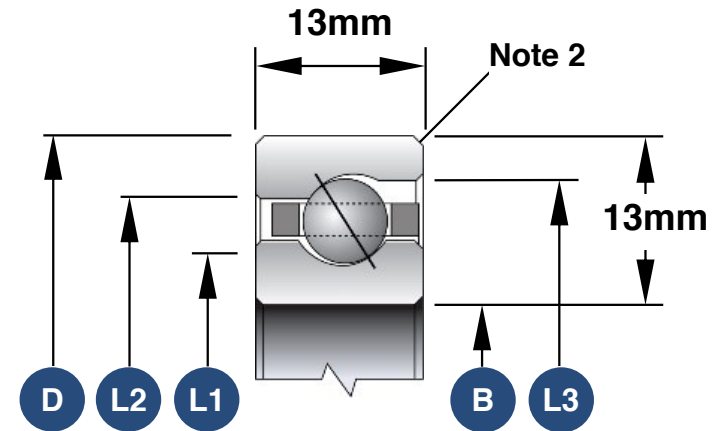

1. Load capacities are not additive
2. The maximum shaft or housing fillet radius that the bearing corners will clear for this series is 1.5mm
3. Race Width Tolerance: +0.000 -0.127mm

Also Available

Open Radial Contact	SM09013CPO
Open 4-Point Contact	SM09013XP0
Open Duplexed (Back-to-Back)	SM09013BR0
Open Duplexed (Face-to-Face)	SM09013FR0